

# 7625 KIMBEL STREET UNITS 15-17

FOR LEASE | MISSISSAUGA, ONTARIO

# EMERY

INVESTMENTS



## BUILDING SPECIFICATIONS

### SIZE:

Warehouse	10,102 sq. ft.
Office	898 sq. ft.
<b>Total</b>	<b>11,000 sq. ft.</b>

### SHIPPING:

Truck Level Doors	3
-------------------	---

### CLEAR HEIGHT:

Clear Height	18'
--------------	-----

### BAY SIZE:

Bay Size	40' x 25'
----------	-----------

### POWER:

Unit 15	30 Amps / 600 Volts
Unit 16-17	200 Amps / 600 Volts

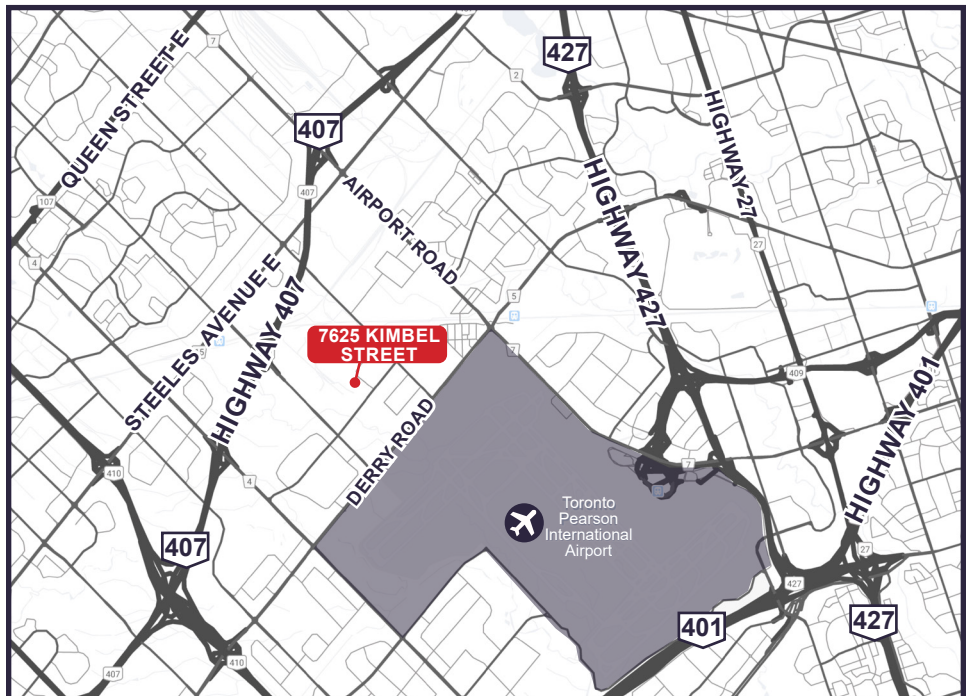

## FOR MORE INFORMATION, PLEASE CONTACT:

**Elana Quinn**  
416-630-6932  
equinn@emeryinvestments.com

**Katharine Giovannetti**  
416-630-6939  
kgiovannetti@emeryinvestments.com

**Emery Investments**  
info@emeryinvestments.com  
www.emeryinvestments.com

# 7625 KIMBEL STREET UNITS 15-17 FOR LEASE | MISSISSAUGA, ONTARIO

# EMERY

INVESTMENTS

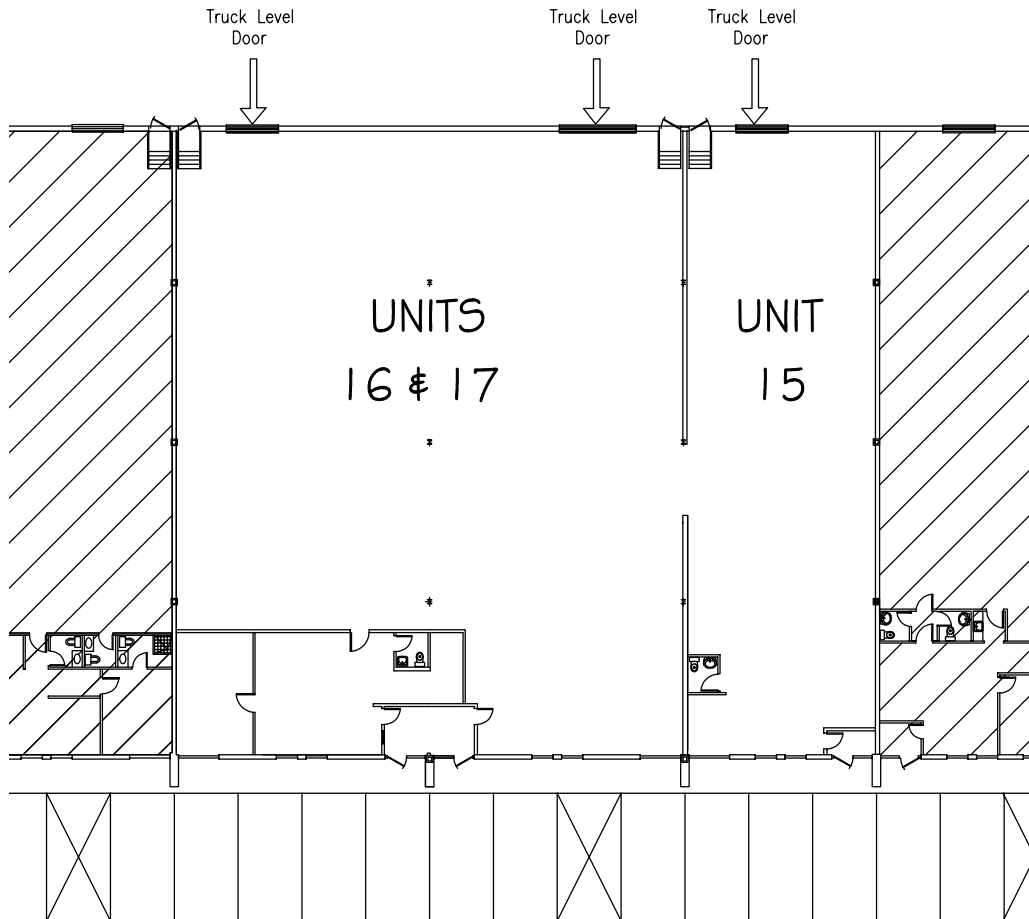

## FEATURES:

- Located just North of Pearson International Airport
- Finished office space
- Unit has new windows
- Ample parking available directly in front of unit
- Easy access to Highways 407, 401, 427, and 410
- Local transit connecting to Islington Subway Station, Malton GO Station, and Pearson UP Express

## FOR MORE INFORMATION, PLEASE CONTACT:

**Elana Quinn**  
416-630-6932

[equinn@emeryinvestments.com](mailto:equinn@emeryinvestments.com)

**Katharine Giovannetti**

416-630-6939

[kgiovannetti@emeryinvestments.com](mailto:kgiovannetti@emeryinvestments.com)

**Emery Investments**

[info@emeryinvestments.com](mailto:info@emeryinvestments.com)

[www.emeryinvestments.com](http://www.emeryinvestments.com)